



TURFPRO MOBILE APP RELEASE & TECHNICAL BULLETIN

Title: Release Mobile App version 4.0.0

Bulletin 2025-001

Scheduled Release Date: August 12, 2025

Date: August 7, 2025

Applicable Devices: Android & iOS

POGO TurfPro is scheduled to release an updated version of the POGO TurfPro Mobile application on or around August 12, 2025. Please find below a preview of the new features.

1- Locating the Mobile App version

To verify the TurfPro Mobile app version loaded in your mobile device, select the “**User Settings**” icon in the lower navigation bar and scroll all the way down to the bottom to read the app version. The most current version is 4.0.0.

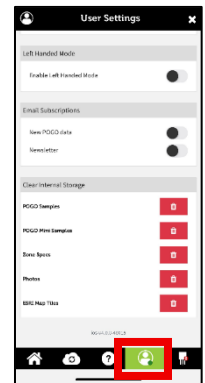

2- New Menu

After selecting a property, the menu appears as displayed in the picture on the right. In this new app release, the previous “**Sample & Log**” button was divided into 3 separate user-friendly screens:

- **POGO Sample.** This feature allows users to log measurements taken with a POGO device. Please note that the icon is locked as off (remains disabled) until a POGO device is connected via Bluetooth to the TurfPro Mobile app.
- **SPEC Sample.** This new feature allows users to manually input standard or custom measurement **specs** via the TurfPro Mobile app with or without a connection to a POGO device (See update 7 below for more details). It facilitates the creation of permanent digital records that are linked to TurfPro.com and can be exported to Excel files. Manual measurements supported by this feature include grass clippings, pin placement, ball speed, firmness, irrigation components and more. Manual logging requires at least one zone created.

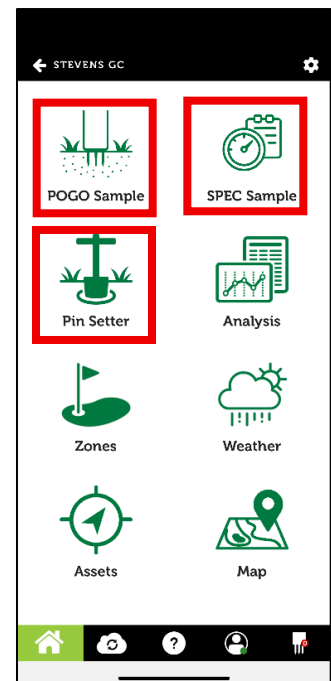

- **Pin Setter.** As in the previous app versions, this feature allows the user to display current pin location as well as new pin positioning and plan future ones.

3- Favorite Properties

Users that manage multiple properties (courses or sports fields) can now mark selected properties as favorites to keep them at the top of the list. A minimum of 5 properties is required to activate the Favorite Properties feature.

4- Sorting Option

Properties can be sorted alphabetically by name or creation date. A minimum of 5 properties is required.

5- Property Search

This feature allows users to quickly find properties by searching by name. A minimum of 5 properties is required.

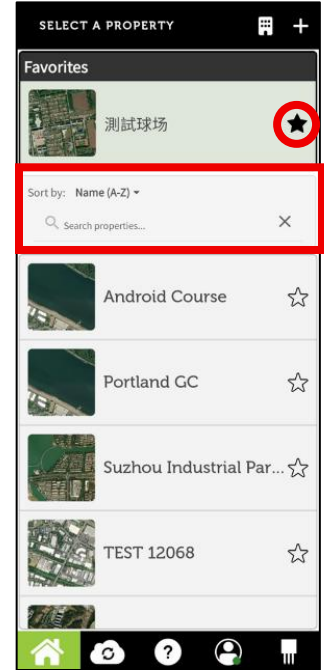

6- Distributor Information

Users can now quickly identify their Distributor's contact details for easier customer access for "Help and Support".

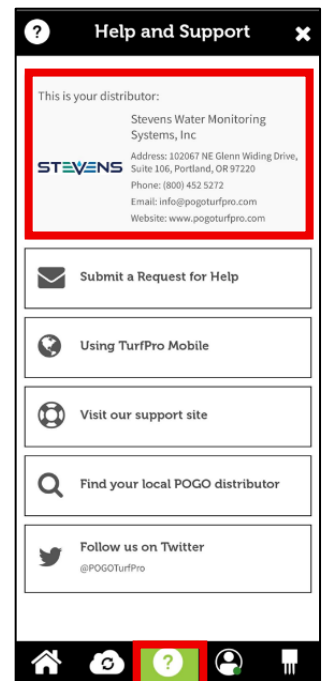

7- Offline Logging – Manual inputs without connecting to a POGO

After selecting a zone to assign the data, users can now log standard and custom specs, and pin locations **without being connected** to a POGO device (Pro/Pro+/Mapper).

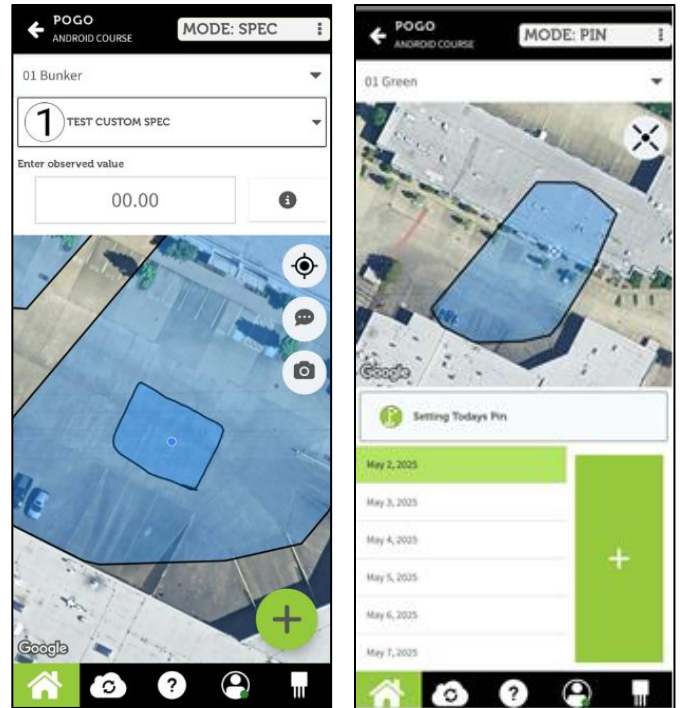

8- Dark Mode

Under the “**User Settings**” tab, users can enable Dark Mode as a preference.

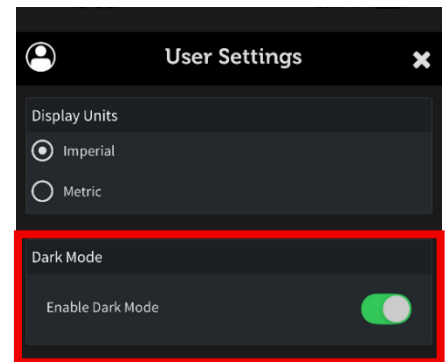

9- Left-Handed Mode

Under the “**User Settings**” tab, below Dark Mode, users can enable Left-Handed mode as a preference. This feature swaps the side of the sample button on POGO Sample, Spec Sample and Pin Setter pages.

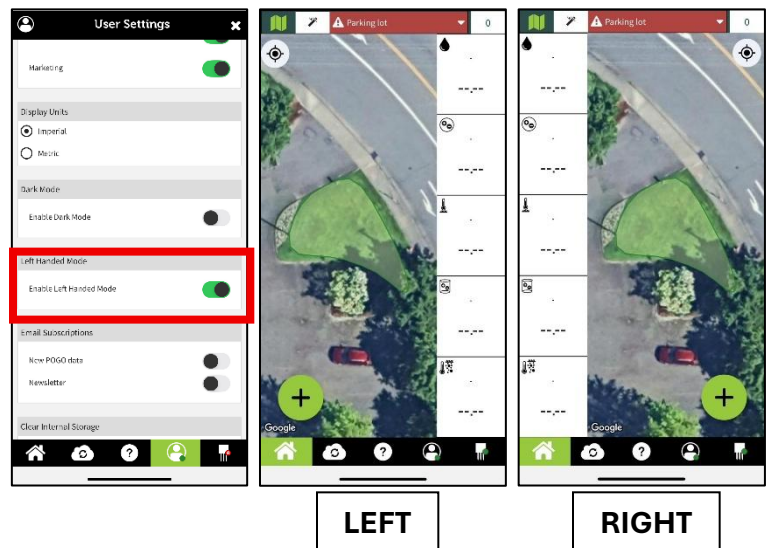

10- Spot Checker

Under the “**POGO Bluetooth Connection**” tab, users can select “**Spot Checker**” to take a quick reading of soil conditions without assigning a pre-existing zone. This feature is only for visual spot checking and not for permanent logging.

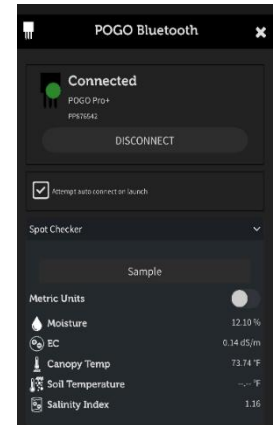
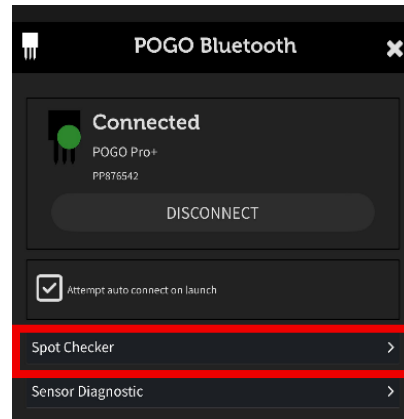

11- Sensor Diagnostic Tool

Under the “**POGO Bluetooth Connection**” tab, users can run a diagnostic of the soil sensor’s health. Selecting this feature will open a “**Sensor Diagnostic**” screen showing the test procedure. It is important to run the test in distilled water. If the moisture reading from the sensor is not within the expected range (76%-82%), the app will auto-generate a sensor replacement request email to info@pogoturfpro.com like the picture on the right below.

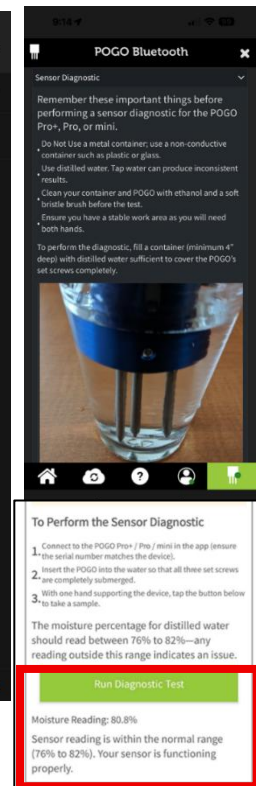
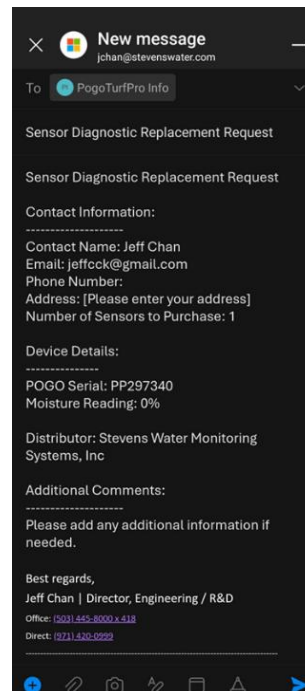
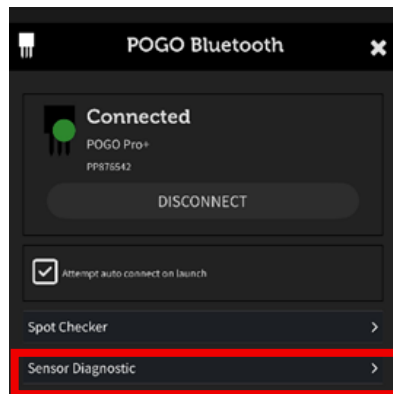

If you have any questions about this bulletin, please contact your POGO Distributor or POGO TurfPro directly at info@pogoturfpro.com or +1-971-4200